

+GF+ PNEUMATICALLY ACTUATED VALVES

FOR CHEMICAL PROCESS APPLICATIONS

AsmuSS build in-house actuation assemblies and can customise to meet your exacting needs, including a wide range of additional accessories. For ease of pricing and ordering we have created a basic actuator assembly kit featuring the appropriate actuator and the adaptor parts to assemble and test a complete actuated valve.

ALL you have to do is select the assembly and add the valve from our manual price list to get your pricing and for ordering purposes. If you require additional functionality, please contact our office.

PA 546 STANDARD PNEUMATIC ACTUATOR ASSEMBLY

	Code	Size (NB)
PA11 Double Acting	PA11546DA/15	15mm
	PA11546DA/20-25	20-25mm
PA21 Double Acting	PA21546DA/32-40	32-40mm
	PA21546DA/50	50mm
PA40 Double Acting	PA40546DA/80	80mm
PA45 Double Acting	PA45546DA/100	100mm
PA11 Fail Close	PA11546/15	15mm
	PA11546/20-25	20-25mm
PA21 Fail Close	PA21546/32-40	32-40mm
	PA21546/50	50mm
PA40 Fail Close / Fail Open	PA40546/80	80mm
	PA40546/100	100mm

PA 567 STANDARD PNEUMATIC ACTUATOR ASSEMBLY

	Code	Size (NB)
PA30 Double Acting	PA30567DA/50-65	50-65mm
PA35 Double Acting	PA35567DA/80	80mm
PA40 Double Acting	PA40567DA/100	100mm
PA50 Double Acting	PA50567DA/150	150mm
PA55 Double Acting	PA55567DA/200	200mm
PA30 Fail Close / Fail Open	PA30567/50-65	50-65mm
PA35 Fail Close / Fail Open	PA35567/80	80mm
PA40 Fail Close / Fail Open	PA40567/100	100mm
PA50 Fail Close / Fail Open	PA50567/150	150mm
PA55 Fail Close / Fail Open	PA55567/200	200mm



Includes PA11/21/40/45 Actuator, Drive Adaptors and Multifunction unit used for the 546 Ball Valves.

VALVE IS NOT INCLUDED



Includes PA30/35/40/50/55 Actuator, Drive Adaptors and Multifunction unit used for the 567 Ball Valves.

VALVE IS NOT INCLUDED

+GF+ PNEUMATICALLY ACTUATED 3 WAY- BALL VALVES

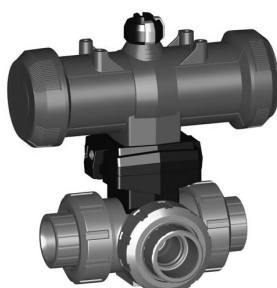

The 285-288 model incorporates the +GF+ 543 3-Way Ball Valve and a compact pneumatic actuator available in either L or T-Port configuration. The L-Port configuration normally requires a 2 position 90 degree actuator whilst the T-Port valve may require a 3 position Electric Actuator. Available Fail Safe Close, Fail Safe Open or Double Acting. A visual position indicator shows valve position. Please contact us for the valve material and the actuator configuration you require.

The 543 Ball Valves are available in PVC, CPVC, ABS, PP & PVDF.

Refer to the 543+GF+ Brochure for more configuration details.

THE SMARTER CHOICE.

+GF+ PNEUMATICALLY ACTUATED VALVES

FOR CHEMICAL PROCESS APPLICATIONS

+GF+ DIASTAR 10 ACTUATED VALVE

	Code	Size (NB)		Code	Size (NB)
PVC-U, Fail Close EPDM Diaphragm EPDM O-Rings Socket Union Ends 	VGF10FC/015	15mm	PVC-U, Fail Close PTFE/EPDM Diaphragm FPM O-Rings Socket Union Ends 	VGF10PTFEFC/015	15mm
	VGF10FC/020	20mm		VGF10PTFEFC/020	20mm
	VGF10FC/025	25mm		VGF10PTFEFC/025	25mm
	VGF10FC/032	32mm		VGF10PTFEFC/032	32mm
	VGF10FC/040	40mm		VGF10PTFEFC/040	40mm
	VGF10FC/050	50mm		VGF10PTFEFC/050	50mm

This range is optimally suited for all standard applications up to 10 Bar requiring an automated interface to the processing plant.

+GF+ DIASTAR 6 ACTUATED VALVE

	Code	Size (NB)
PVC-U, Fail Close EPDM Diaphragm EPDM O-Rings Socket Union Ends 	VGF06FC/015	15mm
	VGF06FC/020	20mm
	VGF06FC/025	25mm
	VGF06FC/032	32mm
	VGF06FC/040	40mm
	VGF06FC/050	50mm

The Diastar 6 is a cost effective solution for operation pressures up to 6 Bar.
It combines high quality with basic actuator functions.
Its compact construction is also an advantage.
Available in a range of materials with the fail close only.

Accessories:

- Limit Switches
- DSR 500 Electro-pneumatic Positioners

OPTIONS & ACCESSORIES

	Type	Manual Override				Pneumatically Operated			
		514	515	517	519	Diastar 6	Diastar 10	Diastar 16	
	Description	True Union Type	Spigot	Flange	Branched Valve				
	Dimensions	DN15 - DN50							
	Pressure Rating	PN10 / PN16*				PN6	PN10	PN16	
Functions	FC					✓	✓	✓	
	FO						✓	on request	
	DA						✓	on request	
Materials	PVC-U	✓	✓	✓		✓	✓	on request	
	PVC-C	✓	✓	✓		✓	✓	on request	
	ABS	✓	✓			✓	✓	on request	
	PP-H	✓	✓	✓	✓	✓	✓	on request	
	PP-n		✓				✓	on request	
Connection Type	PVDF	✓	✓	✓	✓		✓	✓	
	PVDF-HP	✓	✓		✓		✓	✓	
	Socket	✓				✓	✓	✓	
	Spigot	✓	✓		✓	✓	✓	✓	
	Flange			✓		✓	✓	✓	
Diaphragm Materials	Threaded Socket	✓				✓	✓	✓	
	EPDM	✓	✓	✓	✓	✓	✓	✓	
	PTFE/EPDM	✓	✓	✓	✓		✓	✓	
	FPM	✓	✓	✓		on request	on request	on request	
	NBR	✓	✓	✓		on request	on request	on request	
Accessories	Feedback	✓	✓	✓	✓		✓	✓	
	Manual Override						✓	✓	
	Stroke Limiter						✓	✓	
	Positioner						✓	✓	
	Bus Connection					on request	✓	✓	